



**DEPARTMENT OF ENVIRONMENT AND NATURAL RESOURCES
KAGAWARAN NG KAPALIGIRAN AT LIKAS YAMAN**



MEMORANDUM

FOR/TO : **THE ADMINISTRATOR**
National Mapping and Resource Information Authority

THE DIRECTORS
Ecosystems Research Development Bureau
Environmental Management Bureau
Forest Management Bureau
Land Management Bureau
Mines and Geosciences Bureau
Climate Change Service
Knowledge and Information Systems Service

THE REGIONAL EXECUTIVE DIRECTOR
All Regions (except CAR)

THE EXECUTIVE DIRECTOR
River Basin Control Office
Manila Bay Coordinating Office
Palawan Council for Sustainable Development Staff

FROM : **THE UNDERSECRETARY**
Integrated Environmental Science

SUBJECT : **INVITATION TO PARTICIPATE IN THE MANGROVE MAP
VALIDATION LAUNCH ON FEBRUARY 28, 2024**

DATE : **FEB 16 2024**

The DENR Geospatial Database Office (GDO) and the Philippine Space Agency (PhilSA) together with the Biodiversity Management Bureau (BMB) will be officially launching the National Mangrove Map 2023 to the public along with a quick methodology for field validation. The hybrid event serves as the official commencement of the ground validation phase for the nationwide mangrove mapping initiative. It aims to bring together PhilSA, DENR national and local offices, the academe and NGOs such as members of the Global Mangrove Alliance to discuss the methodology behind the satellite-derived map and present and establish protocols for the forthcoming validation activities.

In this regard, your office is invited to attend the **Mangrove Map Validation Launch Event** online through zoom on February 28, 2024 from 9:00-12 noon. Participants will need to register in advance for this meeting through this link: <https://bit.ly/Mangrove-Map-Launch>. After registering, they will receive a confirmation email containing information about joining the online activity.

For the regional offices, representatives from the Manila Bay Site Coordinating and Management Office (MBSCMO), the Conservation and Development Division (CDD) and the National Greening Program (NGP) are enjoined to virtually attend the event for their feedback and participation in the validation activity.

Two (2) representatives from the Forest Management Bureau (FMB) and the National Mapping and Resource Information Authority (NAMRIA) are expected to physically attend the event at the Social Hall of DENR Central, Visayas Avenue.

Enclosed is the tentative program along with the proposed guide for mangrove validation. For further clarifications or inquiries, you may contact us at (02) 8920 4498 and/or VOIP 1202 or through email at geospatial@denr.gov.ph.

For your appropriate action.

CARLOS PRIMO C. DAVID, Ph.D.

2023 Mangrove Map Validation Manual



4

Set your **Username** and **Email**

This will be used to credit you for your data submissions. You only have to do steps 3 and 4 once.

Form Metadata

User-defined

Username
Not set

Phone number
Not set

Email address
Not set

5

Go back to the start and click **Start new form**. Select the **2023 Mangrove Map Validation Form**

PINAS Network

+ Start new form

2023 Mangrove Map Validation

Version: 20240108112555
ID: 2023-mangrove-map-validation
Added on Tue, Jan 09, 2024 at 10:00

6

Fill out the form. Once done, click **Send** to submit the data entry to our server

You are at the end of 2023 Mangrove Map Validation.

1 You will not be able to make edits once you send. If you need to make changes, "Save as draft" until you're ready to send.

Save as draft Send

Why do we need to validate?



The Philippine Space Agency (PhilSA) produced a Nationwide Mangrove Map for 2023 using remotely sensed images from Sentinel-2. To verify its accuracy, this map needs to be validated through on-the-ground data. This validation process is important because it will enhance the map's reliability and its applicability in supporting coastal management, conservation efforts, and scientific research.

Tools you'll need



- A copy of the PhilSA-produced mangrove map
- Android phone and internet access
- ODK App installed on your Android phone
- Proper fieldwork attire to protect you from the elements

The validation process



The validation process involves on-site data collection to compare and validate the remote sensing-derived mangrove map. This manual outlines the procedures, responsibilities, and tools required for a successful validation.



Thank you very much for participating! Your invaluable contributions and dedicated efforts are instrumental to the success of this validation activity.

✓ Procedure

Using ODK:

- The PhilSA-generated mangrove map will be available in shapefile and png/jpg formats. This map should be printed and distributed to each team.
- PhilSA has pre-identified specific barangays, and we suggest collecting a minimum of 30 points per pre-identified barangay. Additionally, data points can be obtained from barangays that were not initially specified.
- Ensure that these points are located within areas marked by PhilSA as mangroves or in areas that may have been misclassified.
- It is preferable for the points not to be close to each other, if possible.
- Consider collecting valuable data points on the edges of mangrove forests, where they begin to transition to other classes such as coconut and others.
- Use the ODK app to gather data

Using a drone:

- Drone images of the mangrove areas are very much appreciated. If your local offices can capture drone images, please do so. You may use this mangrove imaging procedure produced by University of California San Diego as a guide. Visit the following link: <http://tinyurl.com/UCSDMangroveDrone> or scan the QR code.
- Create an orthomosaic, delineate the mangrove areas and send the files to (dedicated PhilSA email).



📱 Installing the ODK app and using the form

- 1 Download the ODK Collect App to your Android device



- 2 In the Home Screen, select:



Then scan the QR Code:



- 3 Click on the PINAS Icon on the upper right side of the app
Navigate to **Settings > User and device identity > Form metadata**

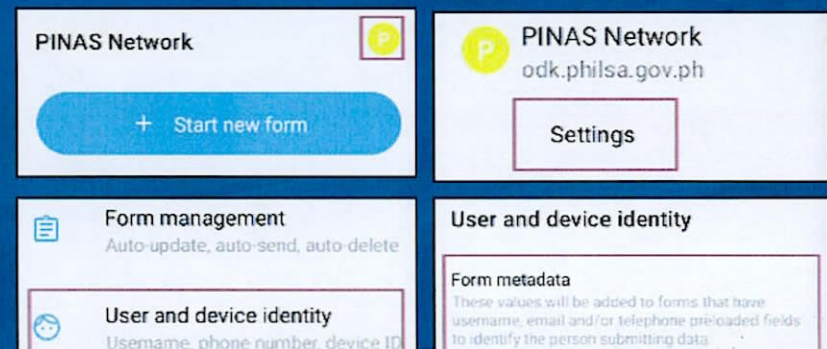

**MANGROVE VALIDATION LAUNCH
TENTATIVE PROGRAM
Feb 28, 2024
8:00 AM – 12:00 NN
Social Hall, DENR Central**

Time	Topic / Activity	Resource person
8:00 AM – 8:30 AM	Registration Preliminaries	DENR
8:30 AM – 8:40 AM	Opening remarks	DENR Geospatial Database Office
8:40 AM - 8: 55 AM	Keynote speech <i>Mangrove rehabilitation in the Philippines</i>	DENR Secretary
8:55 AM - 9:10 AM	Keynote speech The Value of Space in Natural Resource Accounting and Mapping	Director General, PhilISA
9:10 AM – 9:40 AM	Development of the 2023 Mangrove Map <i>Methods Mangrove map viewing via the Space Data Dashboard</i>	Cristan Dave Zablan PhilISA
9:40 AM – 10:10 AM	Mangrove map validation manual <i>Unveiling of the manual ODK installation instructions</i>	Kristine Bantay PhilISA
10:10 AM – 10:25 AM	Health break	
10:25 AM – 11:00 AM	Hands-on: Validation demonstration	PhilISA
11:00 AM – 11:30 AM	Q&A Session and Discussion <i>Suggestions on the validation manual/instructions</i>	PhilISA and DENR
11:30-11:40	Blue Carbon Action Partnership	DENR Biodiversity Management Bureau

11:40-11: 50	Message of Support	Global Mangrove Alliance- Philippine chapter
11:50 AM – 12:00 Noon	Closing remarks	Director of PhilSA/BMB
12 Noon onwards	Lunch Networking	